



Pacific Lampholder Catalog



About us

For over 25 years, McWong International, Inc. has been bridging the best of East and West in order to achieve for our valued customers an unparalleled mix of innovation, quality, and service. A California corporation, McWong has grown to become a leader in the design and manufacture of high quality lighting control equipment and related electrical components. Our teams on both sides of the Pacific take great pride in the fact that the majority of our growth comes from organic nurturing of business with long-term, world-class customers. Reliable, competitive products paired with committed customer service year in and year out have enabled sustained growth over more than two decades.

Today, the pace of technological change has quickened and competition continues to intensify. We are meeting these challenges through heightened investment in capable individuals, promising technologies and advanced manufacturing facilities. McWong's disciplined approach to quality management, customer service, and cost control ensures that we are well-poised to accelerate our pace of growth as we partner with our stakeholders to achieve a brighter, more sustainable, more successful future.

Pacific Lampholder

Pacific Lampholders have continuously served both OEMS and distributors in the lighting industry for over 25 years, and we are proud to say that our products will continue to serve customers for many years to come.

Our clients will receive the very best of both worlds: quality products and reasonable prices.

Innovation

- ❏ Pacific Lampholders are manufactured with quality in mind. Every product is made with meticulous care using only the best materials.
- ❏ Our product can be totally customized to meet our customers' needs.

Quality

- ❏ Our manufacturing team has more than 25 years of experience making high quality porcelain sockets.
- ❏ Our factory in Minqing is ideally situated to make raw materials more accessible and to make shipping quicker and easier.

Service

- ❏ We offer our customers the BEST VALUE. Our unique and highly efficient manufacturing process helps us keep costs down with lower prices and more savings for our customers.
- ❏ Our sales support team is based in the US with great customer service experience.

Contents

Mogul Base	02
Medium Base	04
Medium Base Keyless	06
Medium Base with Pull-chain	07
GU10 & GU24	08

Mogul Lampholders

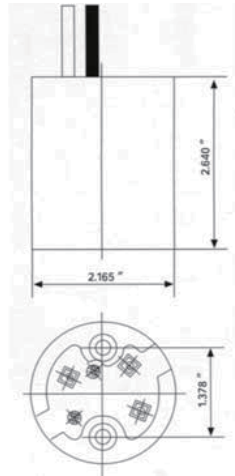

F547-5 cULus Listed

- Rated at 1500W, 600V, 5KV
- Body - glazed porcelain
- Screw shell - nickel-clad brass with cats-eyes
- Center contact - nickel-clad brass, spring loaded, dimpled
- Wire leads : 12", #16 SF-2 200°C 600V, ½" strip
- Mounting: 8-32 threaded bushing

VARIATION

- 8-32 palnut
- Less nuts or bushings
- Antivibration lamp grip screw shell
- Other lead lengths available

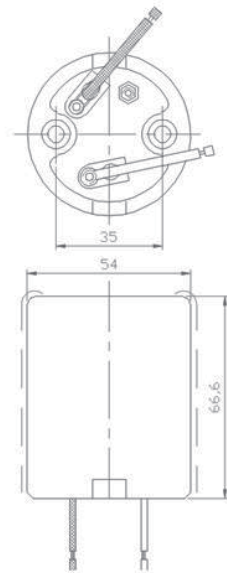

F547-5N cULus Listed

- Rated at 1500W, 600V, 5KV
- Body - glazed porcelain
- Screw shell - nickel-clad brass with cats-eyes
- Center contact - nickel-clad brass, spring loaded, dimpled
- Wire leads : 12", #16 SF-2 200°C 600V, ½" strip
- Mounting: 8-32 threaded bushing

VARIATION

- 8-32 palnut
- Less nuts or bushings
- Antivibration lamp grip screw shell
- Other lead lengths available

Mogul Lampholders

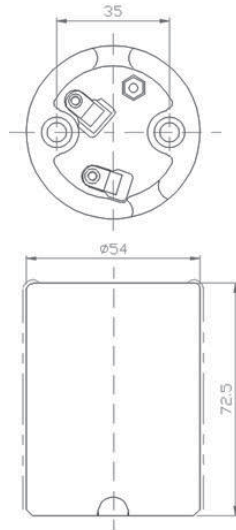

F547-2A cULus Listed

- Rated at 2000W, 600V, 6KV
- Body - glazed porcelain
- Screw shell - nickel-clad brass with cats-eyes
- Center contact - spring steel
- Terminals : .250" recessed tabs- chamfered with hole to secure female receptacle
- Mounting - two 8-32 palnut mount

VARIATION

- 8-32 threaded bushing
- Less nuts or bushings
- Antivibration lamp grip screw shell

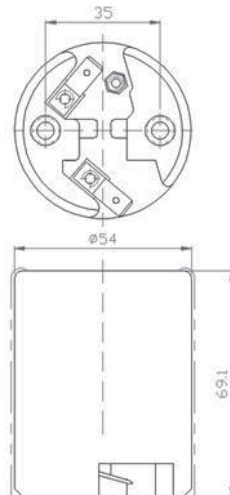

F547-2B cULus Listed

- Rated at 1500W, 600V, 5KV
- Body - glazed porcelain
- Screw shell - nickel-clad brass with cats-eyes
- Center contact - spring steel
- Terminals : .250" horizontal tabs- chamfered and indented to secure female receptacle
- Mounting - through-holes only

VARIATION

- 8-32 threaded bushing
- 8-32 palnut mount
- Antivibration lamp grip screw shell

Medium Lampholders

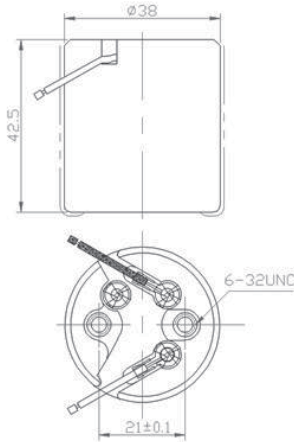

F502F cULus Listed

- Rated at 660W, 250V, 4KV
- Body - glazed porcelain
- Screw shell - nickel-clad brass
- Center contact - nickel-clad brass
- Wire leads : 9", #18 SF-2 200°C 600V, ½" strip
- (0019) Mounting - 6-32 threaded bushing

VARIATION

- (0073) 6-32 mounting screws
- (0068) 5.5" white lead and 4" black lead w/ terminal connector
- Other lead lengths available

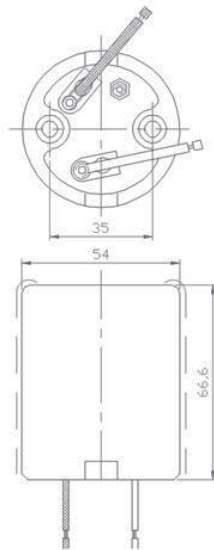

CM-267-2-T UL Listed

- Rated at 660W, 250V
- Body - glazed porcelain
- Screw shell - nickel-clad brass
- Center contact - nickel-clad brass
- Two screw terminals
- Mounting - 6-32 threaded bushing

Medium Lampholders

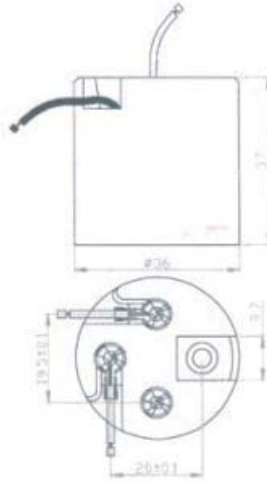

SK011L UL Listed

- Rated at 660W, 250V
- Body - unglazed porcelain
- Screw shell - aluminum
- Center contact - copper or nickel-clad brass
- Wire leads : 6", #18 VW-1 105°C 600V, ½" strip

VARIATION

- SK-011LA with metal hickey mount
- SK-011LB with 8-32 threaded bushing
- Copper or nickel-clad brass shell
- Copper or nickel-clad brass center contact

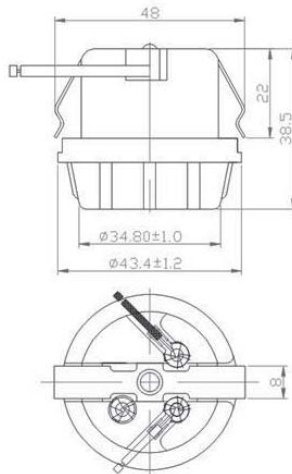

F526 cULus Listed

- Rated at 660W, 600V, 4KV
- Body - glazed porcelain
- Screw shell - nickel-clad brass
- Center contact - nickel-clad brass
- Wire leads : 6", #18 SF-2 200°C 600V, ½" strip
- Aluminum mounting clip secured to body by rivet

VARIATION FOR 660W, 600V

- A) #18 SF-2 B,W,&G wire leads
- B) two screw terminals
- C) two ¼" Single male tab
- D) one screw terminal and one dual male tab

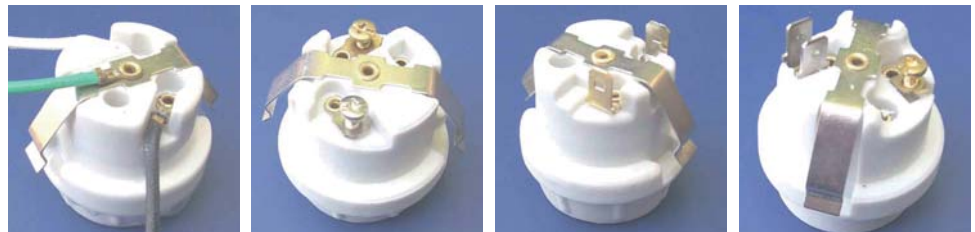

Medium Lampholders Keyless

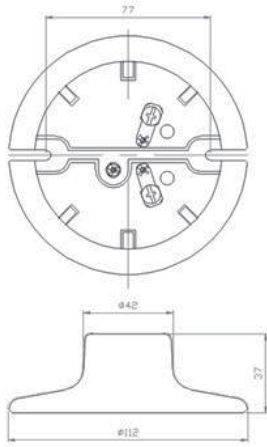

F507-1 cULus Listed

- Rated at 660W, 250V
- Body glazed porcelain
- Screw shell - aluminum, copper alloy or nickel-clad brass
- Two screws - copper alloy, wire binding type.
- Center Contact - copper alloy secured to body by rivet and indented to prevent rotation

VARIATION

- Available with dual screw terminals (see below)

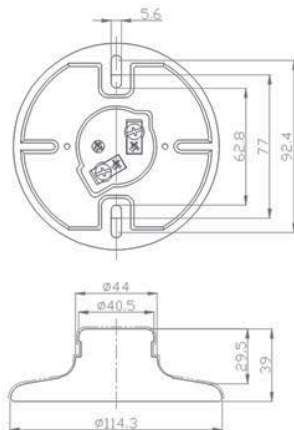

F507-2 cULus Listed

- Rated at 660W, 250V
- Body glazed porcelain with shade groove.
- Screw shell - aluminum, copper alloy or nickel-clad brass
- Four screws -copper alloy, wire binding type.
- Center Contact - copper alloy secured to body by rivet and indented to prevent rotation

Medium Lampholders Pull-Chain

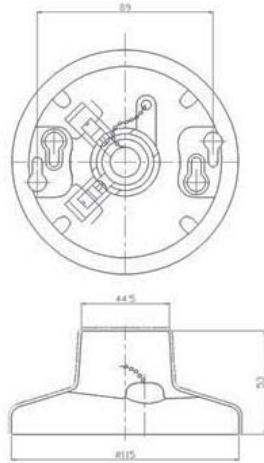

F507-4 cULus Listed

- Rated at 660W, 250V
- Body - glazed porcelain
- Screw shell - aluminum, copper alloy or nickel-clad brass
- Two screws - copper alloy, wire binding type.
- Center Contact - copper alloy secured to body by rivet and indented to prevent rotation

VARIATION

- DT Available with dual screw terminals (see below)

GU10 & GU24 Lampholders

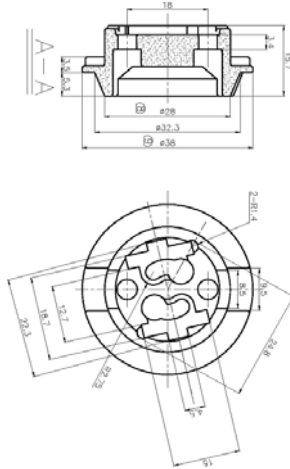
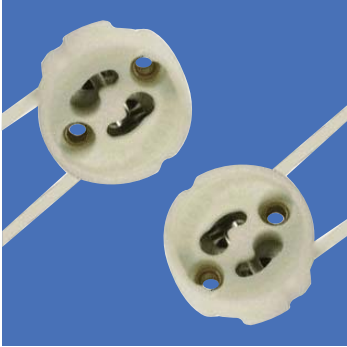

GU10 cULus Listed

- Rated at 660W, 250V
- Body - glazed porcelain
- Mounting - M3 screws
- Contact-copper alloy secured to body by rivet and indented to prevent rotation
- Wire Leads - #18 or #20 UL1015, 1/2" strip

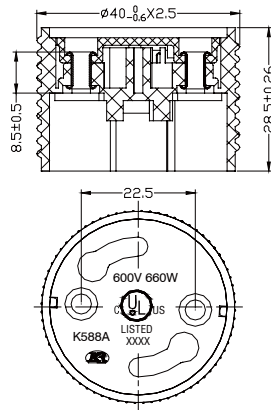
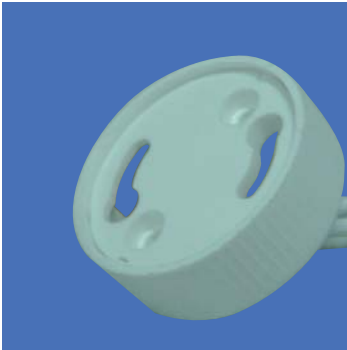

GU24 cULus Listed

- Rated at 660W, 600V
- Body - phenolic
- Mounting - M3 screws
- Contact - copper alloy secured to body by rivet and indented to prevent rotation
- Wire Leads - #18 UL1015, 1/2" strip



MCWONG

McWong International, Inc

1921 Arena Blvd
Sacramento, California 95834
USA

Tel: 916-371-8080
Fax: 916-371-6666

www.McWonginc.com